

1. Make delivery hose adaption to boot (12).  
Some common methods are (depending on delivery hose size).
  - \* Fix a short piece of 1 1/4" or 32 mm poly pipe with a maximum 38 mm OD into boot.
  - \* Most hoses will plug inside or over outside of this pipe.
  - \* Fix delivery hose directly into boot.
  - \* Weld suitable size pipe sleeve onto boot (12) to accept delivery hose.
2. Bolt boot (12) to bracket (11) using items 13, 14 & 15, after determining a suitable height.
3. Loosely bolt holder (2) and bracket (11) to tyre using items 5, 6, & 7.
4. Fit U bolt (8) using item 9 & 10 to secure - **DO NOT OVER TIGHTEN**. Tighten nuts (6) securing holder (2) and bracket (11).
5. Fit point (1) into holder (2), fit pin (3) through point and secure with split pin (4). Ensure that one leg of split pin is sufficiently bent to retain.

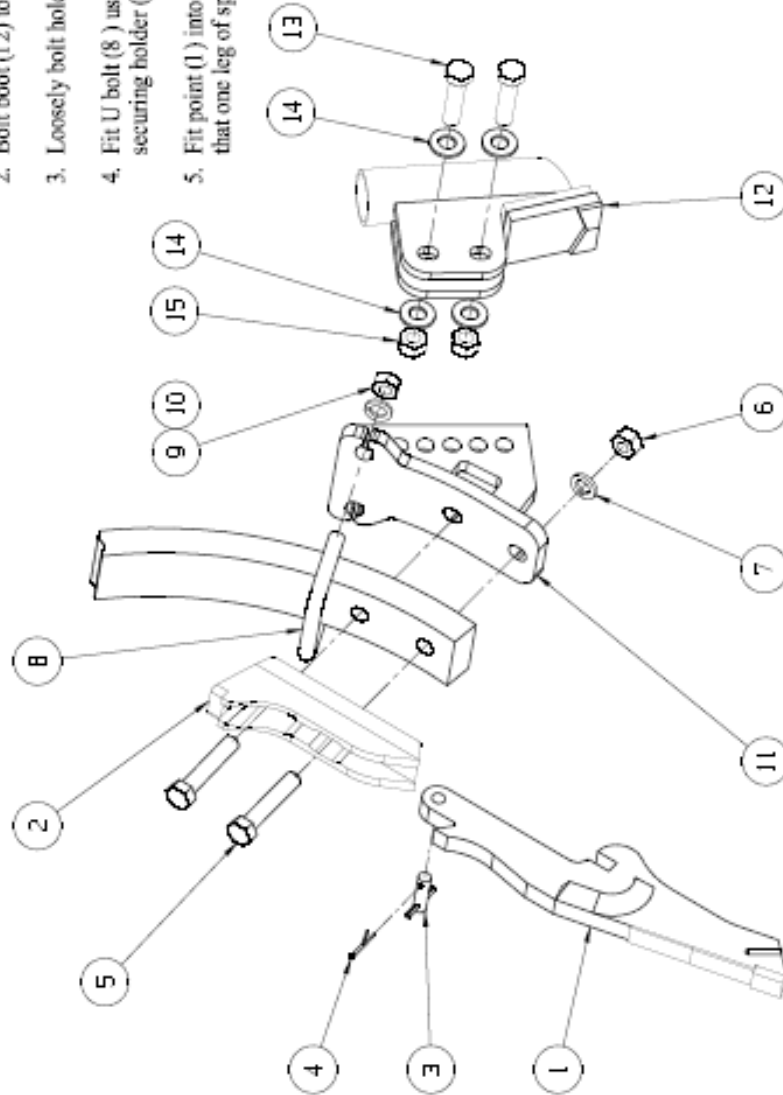

REF	QTY	PART No	DESC
15	2	HU13CL	NUT 1/2" UNF
14	4	V413F	HARDENED WASHER 1/2"
13	2	B0122	BOLT 1/2" UNF X 2"
12	1		BOOT - TO SUIT APPLICATION
11	1		BRACKET - TO SUIT TYRE
10	2	V413HF	FLAT WASHER H/2
9	2	HU13HHV	HEXLOC NUT H/2
8	1	UB2002	U BOLT FOR UP TO 38 WIDE TYRES
8	1	UB2001	U BOLT FOR 50 WIDE TYRES
7	2	V413F	FLAT WASHER 1/2"
7	2	V4716F	FLAT WASHER 7/16"
6	2	HU13CL	NUT 1/2" UNF
6	2	HU716CL	NUT 7/16" UNF
5	2	B0123	BOLT 1/2" UNF X 3"
5	2	B013212	BOLT 1/2" UNF X 2 1/2"
5	2	B0716234	BOLT 7/16" UNF X 2 3/4"
4	1	PT423PL	SPLIT PIN
3	1	TP118D	PIN ASSY
2	1		HOLDER - TO SUIT TYRE
1	1		POINT - TO SUIT TYRE
			DESCRIPTION

AGMASTER  
2057 MARSHALL ST. COLLIE WA 6225

AGMASTER  
2057 MARSHALL ST. COLLIE WA 6225

ASSY INSTRUCTIONS  
NT11 POINTS & BOOTS  
AI1020