

1. Make delivery hose adaption to boot (7).

Some common methods are (depending on delivery hose size).

- * Fix a short piece of 1 1/4" or 32 mm poly pipe with a maximum 38 mm OD into boot. Most hoses will plug inside or over outside of this pipe.
- * Fix delivery hose directly into boot.
- * Weld suitable size pipe sleeve onto boot (7) to accept delivery hose.

2. Bolt boot (7) to bracket (6) using items 8, 9 & 10, after determining a suitable height.

3. Loosely bolt point (1) and bracket (6) to tyne using items 2, & 3.

4. Loosley fit U bolt (4) around top of point and secure thru bracket (6) with nuts (5).

5. Tighten bolt (2).

6. Nip up bolt (4) - DO NOT OVER TIGHTEN

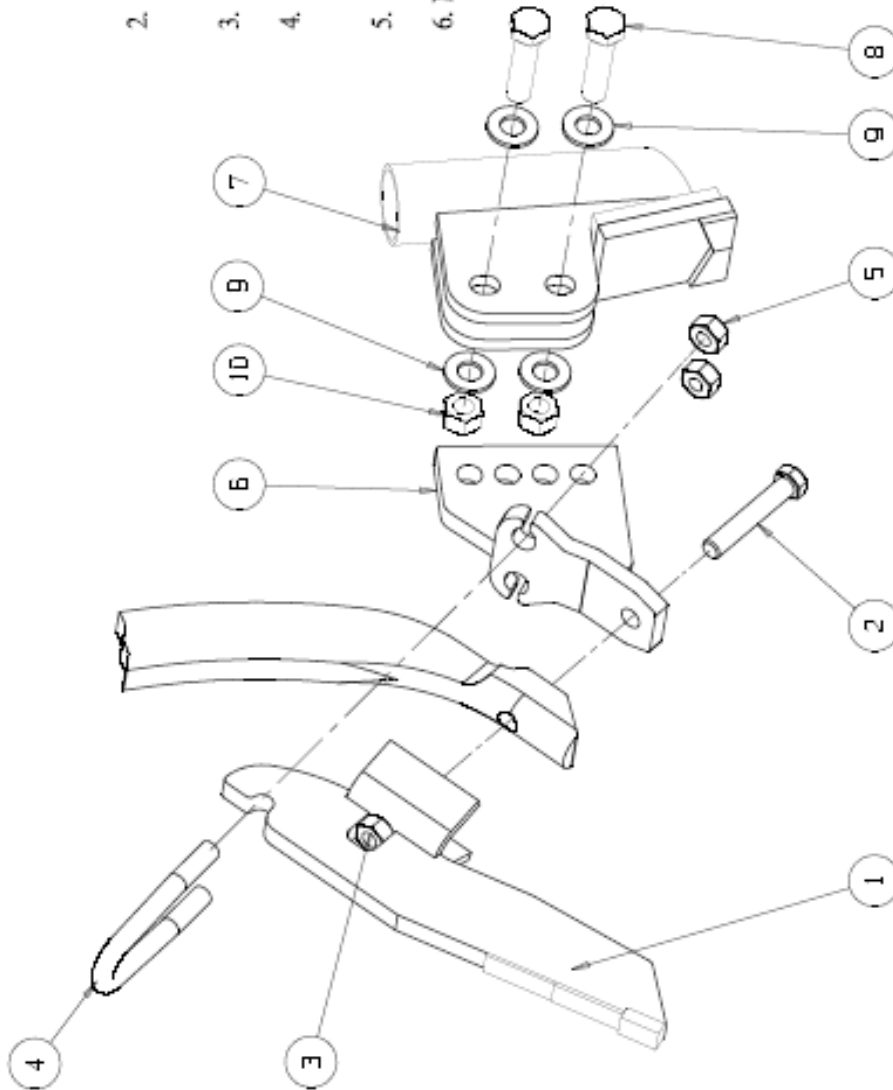

| ID | QTY | PART No | DESCRIPTION |
|----|-----|---------|---------------------------------------|
| 2 | 1 | NUJ20L | NUT 1/2" UNF |
| 3 | 1 | W412F | WASHER 1/2" |
| 4 | 2 | BOJ22 | BOLT 1/2" UNF X 2 |
| 5 | 1 | | NUT - TO SUIT APPLICATION |
| 6 | 1 | | BRACKET - TO SUIT TYNE |
| 7 | 1 | | NUT 1/2" |
| 8 | 1 | UR3003 | U BOLT FOR SC-PISTERS |
| 9 | 1 | UR3004 | U BOLT FOR SEEDERS |
| 10 | 1 | NUJ20L | NUT 1/2" UNF FOR SC-PISTERS |
| 11 | 1 | NUJ16CL | NUT 7/16" UNF FOR SEEDERS |
| 12 | 1 | BOJ22J4 | BOLT 1/2" UNF X 2 1/4" FOR SC-PISTERS |
| 13 | 1 | BOJ16J2 | BOLT 7/16" UNF X 2 1/2" FOR SEEDERS |
| 14 | 1 | | PODIT - TO SUIT TYNE |



ASSY INSTRUCTIONS
NT08 POINTS & BOOTS
A11010

ALL PARTS SHOWN ARE TO BE USED AS SHOWN. IF YOU REQUIRE ANY PARTS NOT SHOWN, PLEASE CONTACT US FOR A QUOTE.
AGMASTER PARTS DEPT.